

TAMWORTH REGIONAL COUNCIL

ENTRANCE STRATEGY

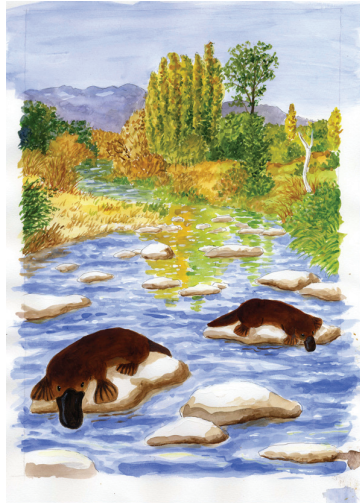
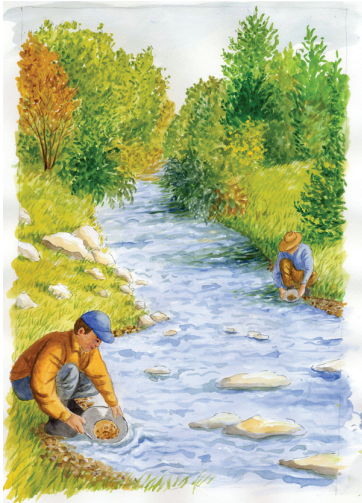

SUMMARY REPORT

PREPARED BY: STEWART SURVEYS PTY LTD AND DANTHONIA DESIGNS PTY LTD | REPORT, VERSION 6 | 13 JUNE 2023

Report Preparation



This Signage Strategy report has been prepared by our office for endorsement by Tamworth Regional Council. To the best of our knowledge, the content of this strategy is true in all material particulars and does not, by its presentation or omission of information, materially mislead.

Name: Kathryn Stewart
Qualifications: Bachelor of Landscape Architecture (UNSW)
Masters of Environmental Management (UNSW)
Registered Landscape Architect (#001493)

Company: Stewart Surveys Pty Ltd
ABN: 65 002 886 508
PO Box 592, Gunnedah NSW 2380
(02) 6742 2966
office@stewartsurveys.com

The graphic design of the signs presented in this strategy was prepared by:

Company: Danthonia Designs Pty Ltd
ABN: 93086857310
4188 Gwydir Highway, Elsmore NSW 2360
(02) 6723 2100
info@danthonia.com.au

ACKNOWLEDGMENT OF COUNTRY

We acknowledge and respect Aboriginal Peoples of Australia, as the traditional custodians of our lands, waters and seas. We recognise their ability to care for Country and their deep spiritual connection with Country. We honour Elders past and present whose knowledge and wisdom ensure the continuation of Aboriginal culture.

TABLE OF CONTENTS

1.	INTRODUCTION	3
2.	SITE ANALYSIS	4
3.	CONSULTATION PROCESS	5
	3.1 STAGE 1 COMMUNITY CONSULTATION, KEY FINDINGS	5
	3.2 STAGE 2 COMMUNITY CONSULTATION, KEY FINDINGS	5
4.	ENTRANCE STRATEGY	6
	4.1 TIER 1 SIGNAGE AND ENTRANCES	7
	4.2 TIER 2 SIGNAGE AND ENTRANCES	8
	4.3 TIER 3 SIGNAGE AND ENTRANCES	9
	4.4 TIER 4 SIGNAGE AND ENTRANCES	10
	4.5 PUBLIC ART	11
5.	PROPOSED SIGNAGE	11
	5.1 RECOGNITION OF TRADITIONAL OWNERS	11
	5.2 COST ESTIMATES	11
	5.2.1 TIER 1 SIGN DESIGN	12
	5.2.2 TIER 2 SIGN DESIGN	13
	5.2.3 TIER 3 SIGN DESIGN	19
	5.2.4 TIER 4 SIGN DESIGN	20
6.	PRIORITISATION OF WORKS AND FUNDING	21



Entrance Strategy Executive Summary

1. INTRODUCTION

Stewart Surveys was engaged by Tamworth Regional Council to produce an entrance strategy for the Tamworth Regional Council Local Government Area (LGA). This strategy will guide the embellishment of key vehicular entry points into Tamworth and surrounding towns and villages.

The strategy will include entry signage, landscaping along entry corridors and public art. The key goals of the project are:

- To improve the physical amenity with statement landscaping;
- To strengthen the Tamworth brand with city and town signage; and
- Celebration of the regional culture through recognition of the lands Traditional Owners.

The signage suite includes four types of signs being an entrance sign at the LGA boundaries and three scales of entrance signs based on population. These signs are classified as Tier 1 to Tier 4. The signs will all have a consistent format to strengthen the Tamworth brand but also celebrate and represent the character of each location.

This signage strategy is intended to facilitate the development of well designed and positioned entrance signage and corridor enhancement through landscaping to create a unique, welcoming experience for motorists entering and travelling around the Tamworth LGA.

The presentation of signage in this strategy has been developed in partnership by Stewart Surveys and Danthonia Designs. The range of signage presented in this strategy is one component of a wider wayfinding system, which includes tourism signage, printed maps, vehicle GPS systems, websites, phone applications and marketing materials.

This report is a summary report of the Entrance Strategy and only presents the key information on the scope and outcome of the strategy. The full strategy should be referred to for more information.

Entrance Strategy Executive Summary

2. SITE ANALYSIS

Entrance signage and flora corridors are an opportunity for the Tamworth Local Government Area to welcome commuters, tourists and residents alike. Clear signage informing commuters of their location, displays a sense of community pride and can provide education or theming backgrounds on the local area. A review of the existing signage across the TRC LGA identified existing signage is inconsistent, dated, poorly maintained and in some cases non-existent. A sense of arrival is not created for motorists and there is a missed opportunity to excite tourists. In Tamworth a number of Destination Tamworth signs promote the Country Music Festival on main arterial roads but there is a lack of clear entrance identification. Fast food chains billboards dominate the entrance and in some locations an assortment of signs of varying design and themes make the experience seem disjointed, unstructured and in some cases cluttered. Some Towns including Barraba and Kootingal have significant unique placemaking signage which is an important part of the local identity. Some villages have unique signage which lacks cohesion with the rest of the shire. Dedicated entrance corridors are sparse, however where in place are maintained to a high standard. Signage is not lit or headlight reflective. There is no existing public art in any of the entrance corridors in the LGA. A new public art installation is proposed at the new roundabout on the Gunnedah Road approach to Tamworth.

There is great opportunity across the shire to create a welcoming and attractive entrance to the city, towns, villages and LGA. The enhancement of existing entrance corridors and creation of new entrance flora corridors will build on the aesthetic and pride of place in each locality. The New Winton Road entrance for visitors arriving by air warrants improvement to create a cohesive approach to the entrances and placemaking of the City of Tamworth, surrounding towns and villages. The images in this report depict some of the signage styles observed around the Tamworth LGA.

Figure 1 Examples of Existing Signage

LGA Boundary Signage



Tamworth Airport



Tamworth Signage





Entrance Strategy Executive Summary

3. CONSULTATION PROCESS

The consultation undertaken to produce the Tamworth Regional Council Entrance Strategy was guided by a Communication and Engagement Strategy which was developed by Tamworth Regional Council. A multi stage approach to this was developed to ensure the community and key stakeholders had the opportunity to contribute to the development of the Strategy, and to ensure that the values and aspirations of the community and stakeholders are reflected in the Strategy.

3.1 STAGE 1 COMMUNITY CONSULTATION, KEY FINDINGS

Community comments included:

Signs

- Current signage is terrible;
- Desire uniformity;
- Want the signs to acknowledge TRC;
- Recognition of Traditional Owners is critical;
- Desire unique element for each town / village;
- Bespoke signs, such as Murrurundi & Broken Hill, are amazing;
- The location of the signs is critical; and
- Supportive of tiered sign structure.

Flora Corridor

- Flora corridors are desired;
- Flora Corridors are a great way to draw travellers into villages; and
- The species selection is critical.

Public Art

- Public art is desired.

3.2 STAGE 2 COMMUNITY CONSULTATION, KEY FINDINGS

The project webpage was visited 1,575 and multiple hard copies of the strategy were collected from Council offices. In total 120 formal submissions were made to Council regarding the project. A summary of the feedback received during this period is below:

- 17 positive responses regarding Strategy on a whole / specific element in strategy / sign designs;
- 11 contributors didn't like the sign design;
- 6 contributors didn't like the corporate styling (colour / fonts);
- 2 contributors like current signage; and
- 95 contributors voted on the design of individual Tier 2 signs.

Entrance Strategy Executive Summary

4. ENTRANCE STRATEGY

The entrance strategy proposes three key components for each signage location.

- Entrance Signage;
- Flora Corridors; and
- Public Art (Tier 1 and 2 locations)

The tables below outline the proposed Tier 1, 2 and 3 locations in the entrance strategy. Figure 2 shows the locations within the Tamworth LGA.

TIER 1 - Tamworth City Entrances

Oxley Highway / Gunnedah Road
New England highway / Armidale Road
New England highway / Goonoo Goonoo Road
Duri Road
Manilla Road
New Winton Road

TIER 2 Locations

Barraba
Bendemeer
Kootingal
Manilla
Moonbi
Nundle

TIER 3 Locations

Attunga
Daruka
Dungowan
Duri
Hanging Rock
Limbri
Nemingha
Niangala
Piallamore
Somerton
Woolbrook

The following section of the report includes the key recommendations for each entrance location.

**Figure 2 -
Locality Overview**

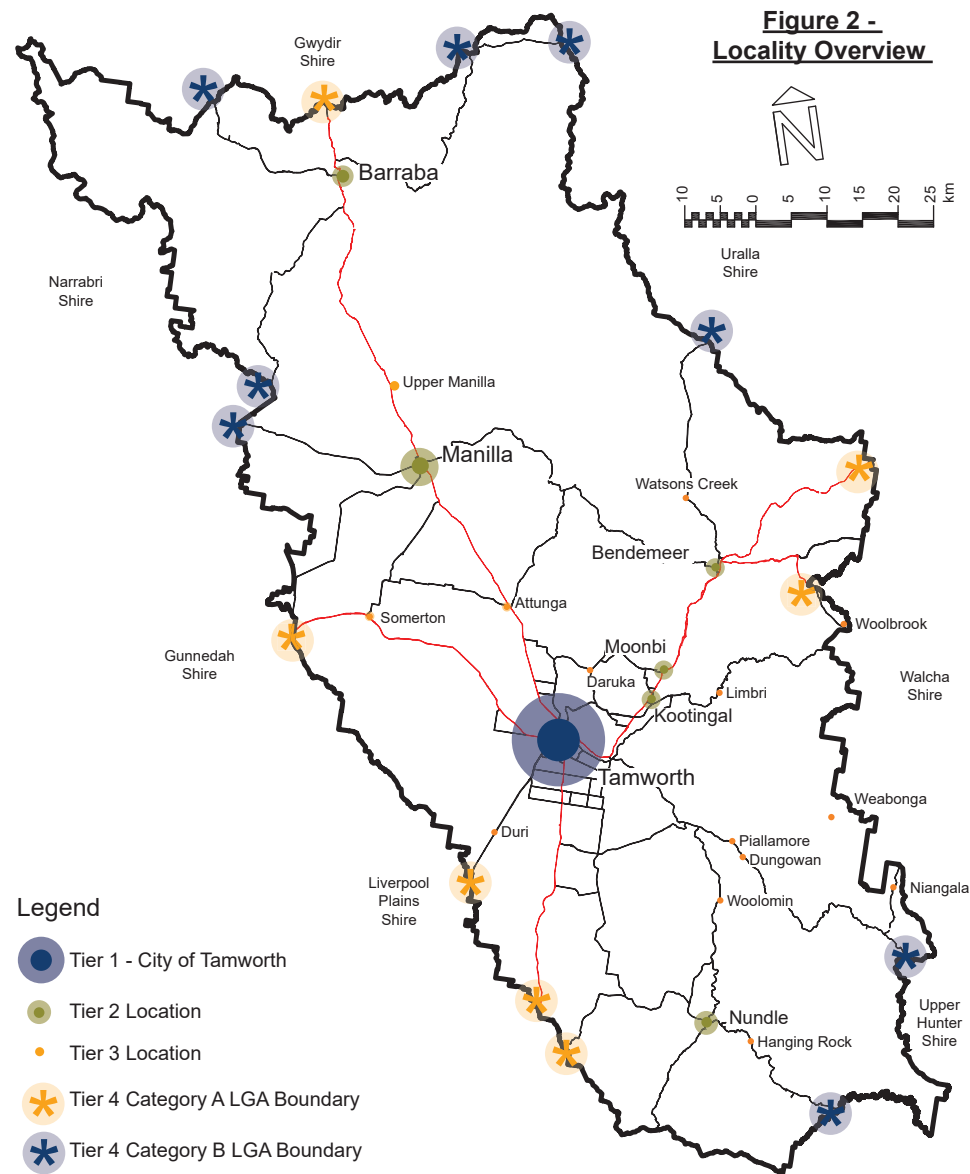

Entrance Strategy Executive Summary

4.1 TIER 1 SIGNAGE & ENTRANCES

It is proposed to install Tier 1 scale signage to the six key entrances into the city of Tamworth. In determining the entrances into Tamworth we have considered the current TRLEP, 2010 residential zoning boundaries and the recommendations of the Blueprint 100 for future residential growth areas.

Figure 5 shows an overview of the City of Tamworth with main roads, future bypasses and residential, commercial and industrial growth areas. The information in this report is taken from the Blueprint 100.

The main vehicle entrances into the City of Tamworth are:

- Oxley Highway / Gunnedah Road and New Winton Road;
- New England Highway / Armidale Road;
- New England Highway / Goonoo Goonoo Road;
- Duri Road; and
- Manilla Road;

Each of these entrances is described in detail in the full Entrance Strategy report. In this section the key recommendations are summarised.

Flora Corridors along the entrances with improve the aesthetic and livability of the City by creating an attractive streetscape, reducing stormwater runoff, increasing air quality, storing carbon, providing shade and reducing the urban heat island effect.

It is proposed to create a sense of arrival at each city entrance through the use of public art. These unique public art pieces will be commissioned by Council to celebrate the history of Tamworth and show the city as a vibrant cultural center for business and residences.

Figure 2 shows reference to each entrance road and an overview of the proposed signage, flora corridors and entrance statement sculpture / public art. This is overlaid

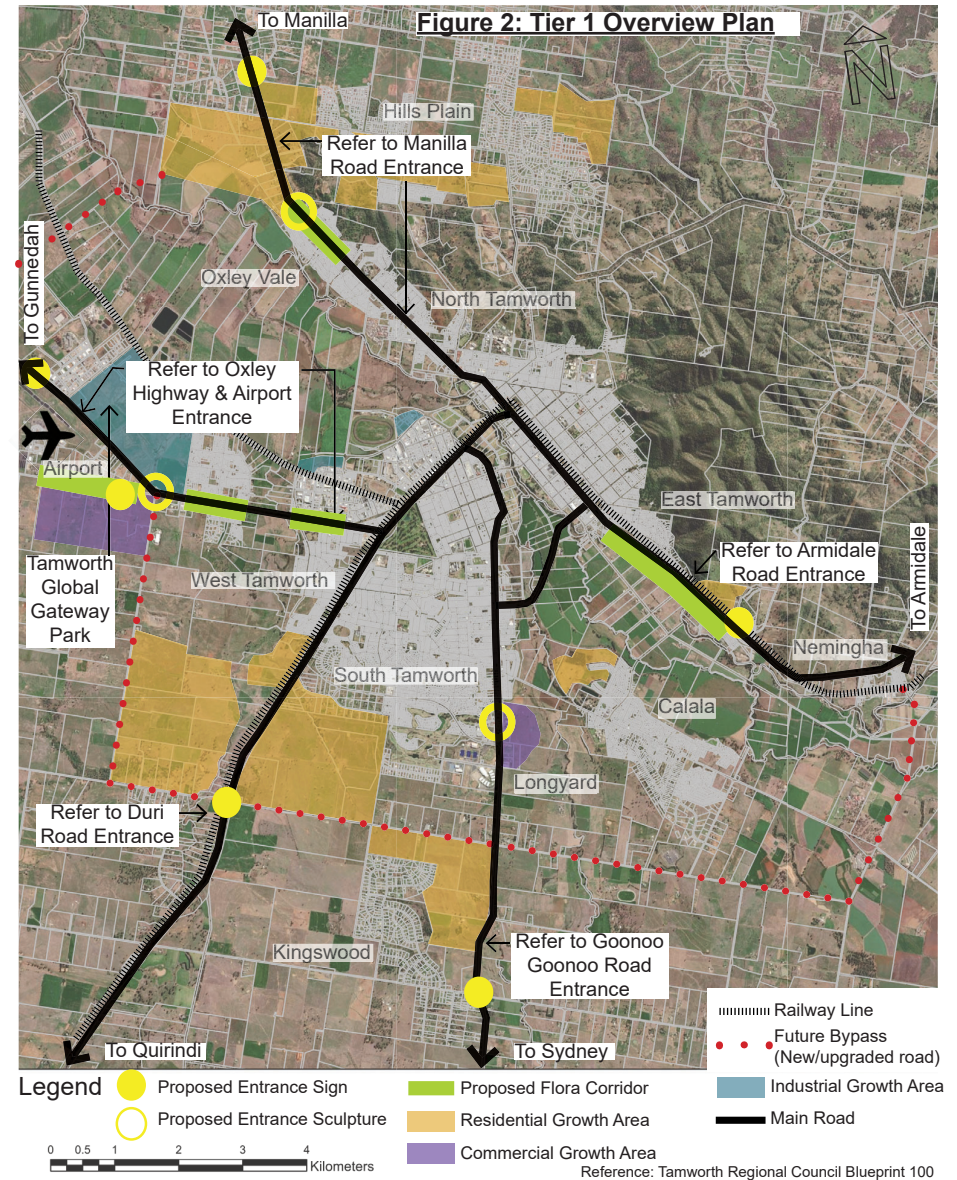

Entrance Strategy Executive Summary

TIER 2 SIGNAGE & ENTRANCES

This report recommends the following locations are provided with Tier 2 signage:

- Barraba
- Bendemeer
- Kootingal
- Manilla
- Moonbi
- Nundle

The categorisation of a locality as either tier 2 is based on the consideration of three elements:

- Population;
- Location; and
- Function.

The signage for each Tier 2 sign includes a unique theme which portrays the character of the locality. The themes were voted by the community and endorsed by Council as follows:

- Barraba – Regent Honey Eater / Bird Watching
- Bendemeer – Platypus in the McDonald River
- Kootingal – Star (Aboriginal meaning for Kootingal)
- Manilla – Paragliding / Water Sports
- Moonbi – Moonbi Ranges / Moonbi Lookout
- Nundle – Gold panning / Fossicking

Refer to the Entrance Strategy for a review of each locality. This executive summary provides the key recommendations.

Figure 17
Tier 2 Locality Overview

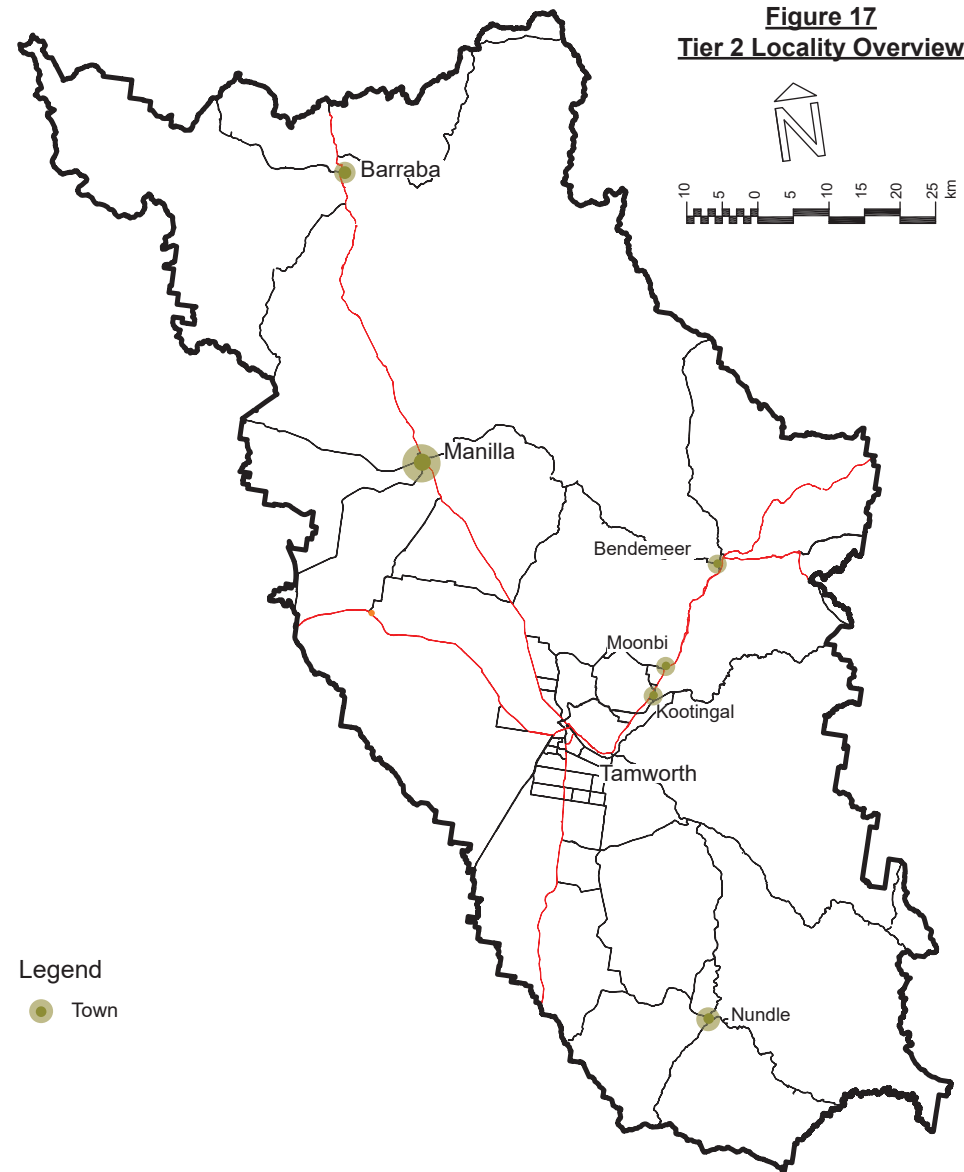

Entrance Strategy Executive Summary

4.3 TIER 3 SIGNAGE & ENTRANCES

In this strategy we have categorisation of a locality as Tier 3 is based on the consideration of three elements:

- Population;
- Through traffic; and
- Proximity to other localities.

It is proposed to install tier 3 scale signage at the following villages in the Tamworth Regional Local Government Area:

- Attunga,
- Daruka,
- Dungowan,
- Duri,
- Hanging Rock,
- Limbri,
- Nemingha,
- Niangala,
- Piallamore,
- Somerton,
- Woolbrook and
- Woolomin.

All existing locality signage at these locations will be removed.

Flora Corridors in Tier 3 Locations

To heighten the sense of arrival and beautify the village locations a flora corridor is recommended through the main thoroughfare.

Street tree plantings will be in accordance with the USTMP and species should create a unique and memorable experience for each location, and be located on each side of the road behind each entrance sign.

Figure 4 shows the location of the Tier 3 signs within the shire.

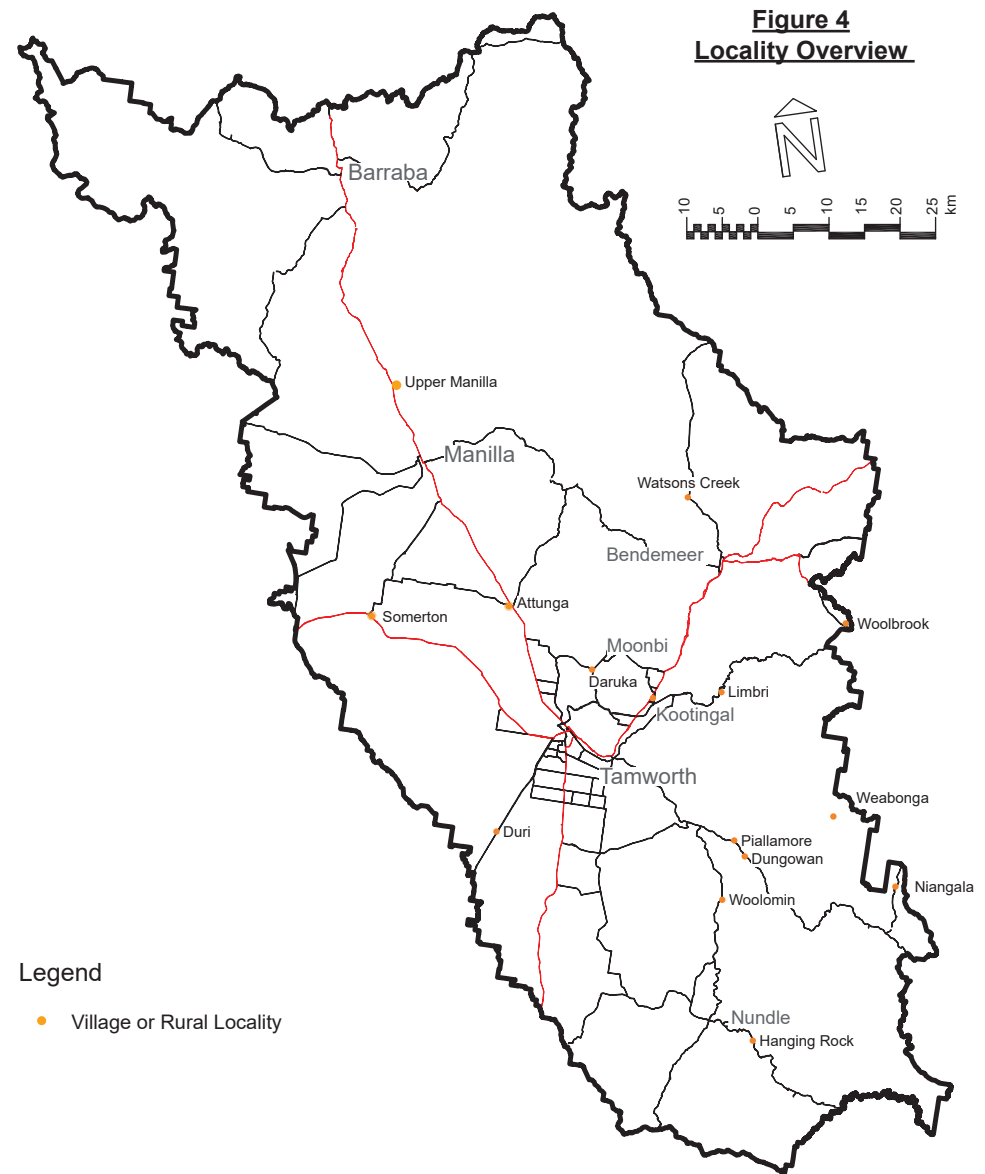

Entrance Strategy Executive Summary

4.4 TIER 4 LGA SHIRE BOUNDARY SIGNAGE

There are a number of entrances into the Tamworth Regional Shire, where it is proposed to install an Tier 4 scale sign. In the site analysis, entrances have been categorised as category A and category B, based on the number of vehicles traveling on each route two scales of signs are proposed for the entrances to the shire. There are a few entrances into the LGA on which a sign has not been proposed. This is due to the low number of vehicles using this route. The following tables outline the proposed Tier 4 entrance sign locations and figure 5 shows the signage location.

Tier 4 - Category A

Location	Adjoining LGA	Easting (GDA94, MGA56)	Northing (GDA94, MGA56)
1.1 Oxley Highway	Gunnedah	264419	6572901
1.2 New England Highway	Liverpool Plains	298041	6519159
1.3 Oxley Highway	Walcha	341933	6575041
1.4 New England Highway	Uralla	345472	6596725
1.5 Bingara Road	Gwydir	268713	6646524
1.6 Werris Creek Road	Liverpool Plains	289064	6538498
1.7 Lindsay's Gap Road	Liverpool Plains	301086	6514486

Tier 4 - Category B

Location	Adjoining LGA	Easting (GDA94, MGA56)	Northing (GDA94, MGA56)
2.1 Rangari Road	Gunnedah	256503	6601966
2.2 Barry Road	Upper Hunter	338108	6504134
2.3 Flags/Niangala Road	Walcha	348569	6536728
2.4 Balala Road	Uralla	332633	6600888
2.5 Bundarra/Barraba Rd	Uralla	301617	6655324
2.6 Gulf Creek Road	Gwydir	289019	6653983
2.7 Trevallyn Road	Gwydir	252875	6647005
2.8 Longarm / Kelvin Rd	Gunnedah	260684	6607473

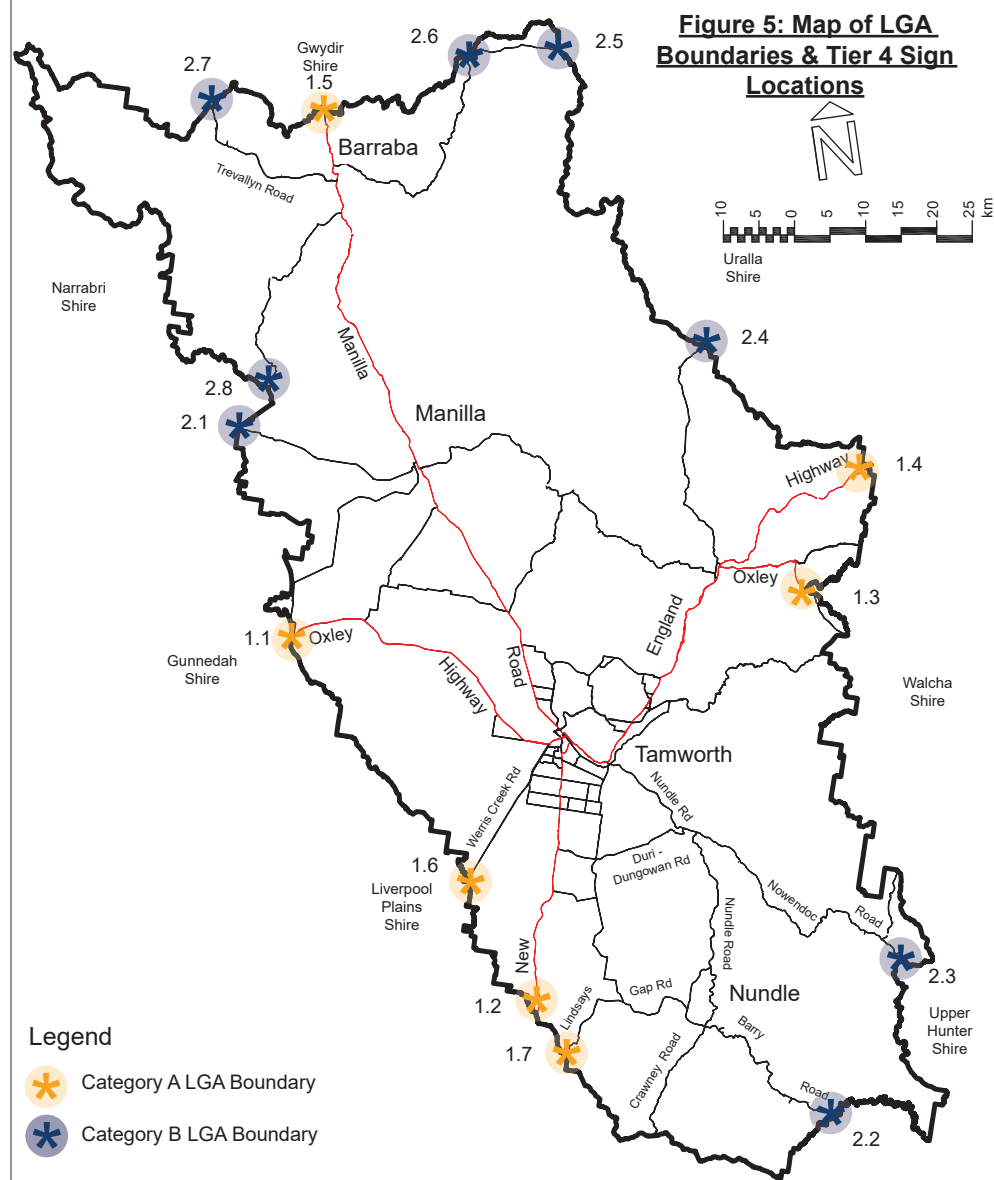



Entrance Strategy Executive Summary

4.5 PUBLIC ART

It is proposed to install a landmark piece of Public Art as part of the entrance strategy for each tier 1 and tier 2 location. During community consultation this public artwork was highlighted as being an important component of this project. Public art enriches the landscape and is an opportunity to build community pride, connect citizens and celebrate the culture of the community. It also highlights each location as a vibrant, creative environment to residents, tourists and investors improving livability through celebration of culture in a tangible public asset.

The theme and final location of each piece of public art will be determined at a later date in conjunction with a local artists.

5. PROPOSED SIGNAGE DESIGN

The signage design suite presented in this strategy is a unified sign system for Tamworth Regional Council that combines bold, contemporary typography with a warm, welcome colour palette in line with Council Style Guide.

Elements of indigenous artwork give credit to the traditional custodians of the Tamworth Region. The sweeping curves lend an informal look to the designs, at the same time suggesting broad, sweeping vistas.

The designer has kept the designs clean, simple and bold, so they are eye-catching to passing traffic.

5.1 RECOGNITION OF TRADITIONAL OWNERS

A key objectives of this strategy is to celebrate regional culture through recognition of the lands Traditional Owners. Consultation with local Aboriginal people and organisations during the preparation of this strategy gave insights into what was important to Indigenous culture and how the traditional owners wished to be represented.

Aboriginal people have resided and moved across this landscape sharing stories of culture and heritage for generations. This has contributed to their identity and gives them a unique perspective on the landscape. To recognise the traditional owners of the land in the entrance strategy we have used four key components being:

- Connection to Country through use of local rock in base of structure;
- Use of local Aboriginal artwork to represent Aboriginal culture;
- Use of themes to tell stories of this land; and

- Acknowledgment of Gamilaroi People

As the entrance signage will be located on the Local Government Area (LGA) boundaries and at the entrances to each village, town and city within the shire, this recognition of the lands Traditional Owners will have a strong presence in the theming and messaging for residences and visitors of the Tamworth Regional LGA. We believe these measures are consistent with feedback from the community consultation on this project.

5.2 COST ESTIMATES

Danthonia Designs have provided an indicative cost estimate, at the time of writing this report, for the manufacture and installation of the each signage tier. These costings allow for single sign shipping and installations. Large savings on these components can be made by group ordering the signage. Installation has been included but may also vary if more than one sign is ordered at the same time. Danthonia have allowed for signs to be delivered fully assembled, so as to install with minimal impact on traffic. Prices have allowed for signs which do not contain retaining walls to be frangible as this is a greater cost to non-frangible signs. Prices do not include any surrounding landscaping.

Solar lighting package including a 375 watt solar panel, 24v lithium battery, pole, bluetooth enabled charge controller and inground LED lights with wide or narrow optical to suit sign type (similar to the example shown in Figure 6.3 in main report) costs are in the order of \$4,200 (ex GST) per light. This price excludes installation and a ball park allowance has been made for installation.

Element	Tier 1	Tier 2	Tier 3 & 4
Sign Design 37083-01 Rev 1	\$27,785.00	\$21,547.00	\$6,819.00
Engineering	\$1,184.00	\$1,184.00	\$425.00
Installation (one only, savings for multiple)	\$9,250.00	\$7,325.00	\$3,786.00
Shipping (one only, savings for multiple)	\$3,831.00	\$1,240.00	\$192.00
Solar Lighting	\$4,200.00	\$4,200.00	N/a
Electrician (estimate only)	\$1,000.00	\$1,000.00	N/a
Retaining Wall	\$6,290.00	\$3,740.00	N/a
TOTAL ESTIMATE (ex GST)	\$53,540.00	\$40,236.00	\$11,222.00

Entrance Strategy Executive Summary

5.2.1 TIER 1 SIGNAGE DESIGN

The Tier 1 signage has an overall size of 4.87 metres long by 3.34 metres high. The Tamworth lettering is 580 millimetres high, retro reflective vinyl to improve visibility at night. The sign can be read from a distance of 200 metres. It is proposed that all Tier 1 signage will be uplit with solar lighting.



Figure 6 Tier 1 Signage Design (Source: Danthonia Designs Pty Ltd)

Entrance Strategy Executive Summary

5.2.2 TIER 2 SIGNAGE DESIGN

Tier 2 locality: Barraba

Theme:

Regent Honey Eater Bird Watching



Tier 2 Specifications:

The Tier 2 sign has an overall size of 3.88 metres long by 2.65 metres high.

The locality name lettering is 540 millimetres high, retro reflective vinyl to improve visibility at night. The sign can be read from a distance of 190 metres. It is proposed that all Tier 2 signage will be uplit with solar lighting.



Stone walls to be constructed of local stone. Masonry work arranged by Council. Stonework will not match this image exactly.

3D RENDER OF MONUMENT SHAPE:

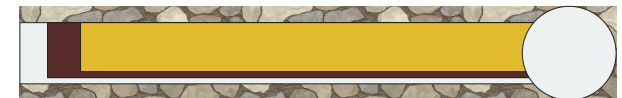
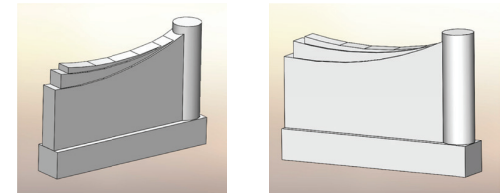

PLAN VIEW



Figure 7 Tier 2 Barraba Signage Design (Source: Danthonia Designs Pty Ltd)

Entrance Strategy Executive Summary



Tier 2 locality: Bendemeer

Theme:

McDonald River/Platapus

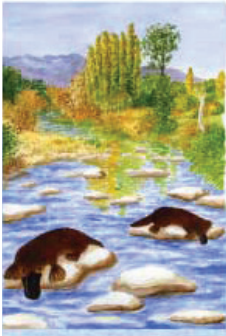

Tier 2 Specifications:

The Tier 2 sign has an overall size of 3.88 metres long by 2.65 metres high.

The locality name lettering is 540 millimetres high, retro reflective vinyl to improve visibility at night. The sign can be read from a distance of 190 metres. It is proposed that all Tier 2 signage will be uplit with solar lighting.



Stone walls to be constructed of local stone. Masonry work arranged by Council. Stonework will not match this image exactly.

3D RENDER OF MONUMENT SHAPE:

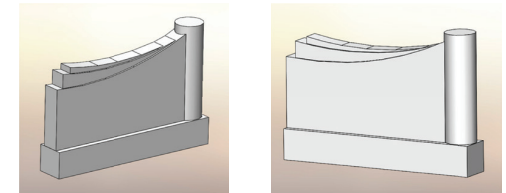

PLAN VIEW



Figure 8 Tier 2 Bendemeer Signage Design (Source: Danthonia Designs Pty Ltd)

Entrance Strategy Executive Summary



Tier 2 locality: Kootingal

Theme:

Tier 2 Specifications:

Star (Aboriginal meaning for Kootingal) The Tier 2 sign has an overall size of 3.88 metres long by 2.65 metres high.

The locality name lettering is 540 millimetres high, retro reflective vinyl to improve visibility at night. The sign can be read from a distance of 190 metres. It is proposed

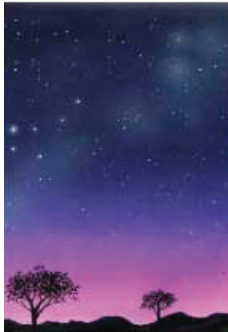

Stone walls to be constructed of local stone. Masonry work arranged by Council. Stonework will not match this image exactly.

3D RENDER OF MONUMENT SHAPE:

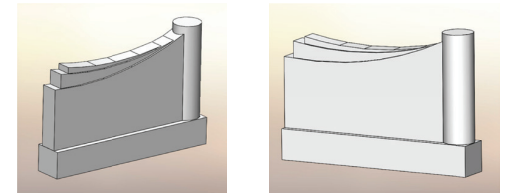

PLAN VIEW



Figure 9 Tier 2 Kootingal Signage Design (Source: Danthonia Designs Pty Ltd)

Entrance Strategy Executive Summary



Tier 2 locality: Manilla

Theme:

Paragliding



Tier 2 Specifications:

The Tier 2 sign has an overall size of 3.88 metres long by 2.65 metres high.

The locality name lettering is 540 millimetres high, retro reflective vinyl to improve visibility at night. The sign can be read from a distance of 190 metres. It is proposed



Stone walls to be constructed of local stone. Masonry work arranged by Council. Stonework will not match this image exactly.

3D RENDER OF MONUMENT SHAPE:

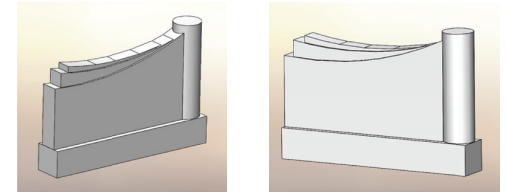

PLAN VIEW



Figure 10 Tier 2 Manilla Signage Design (Source: Danthonia Designs Pty Ltd)

Entrance Strategy Executive Summary



Tier 2 locality: Moonbi

Theme:

Moonbi Ranges/Moonbi Lookout



Tier 2 Specifications:

The Tier 2 sign has an overall size of 3.88 metres long by 2.65 metres high.

The locality name lettering is 540 millimetres high, retro reflective vinyl to improve visibility at night. The sign can be read from a distance of 190 metres. It is proposed



Stone walls to be constructed of local stone. Masonry work arranged by Council. Stonework will not match this image exactly.

3D RENDER OF MONUMENT SHAPE:

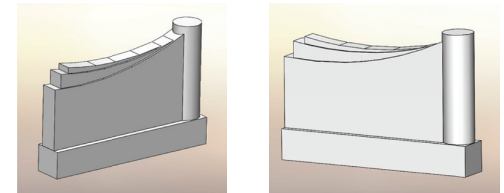

PLAN VIEW



Figure 11 Tier 2 Moonbi Signage Design (Source: Danthonia Designs Pty Ltd)

Entrance Strategy Executive Summary



Tier 2 locality: Nundle

Theme:

Gold Panner Fossicking



Tier 2 Specifications:

The Tier 2 sign has an overall size of 3.88 metres long by 2.65 metres high.

The locality name lettering is 540 millimetres high, retro reflective vinyl to improve visibility at night. The sign can be read from a distance of 190 metres. It is proposed



Stone walls to be constructed of local stone. Masonry work arranged by Council. Stonework will not match this image exactly.

3D RENDER OF MONUMENT SHAPE:

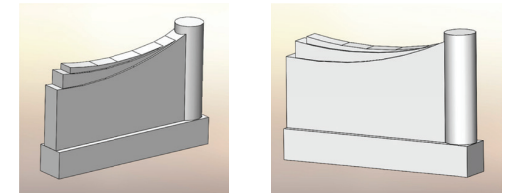

PLAN VIEW

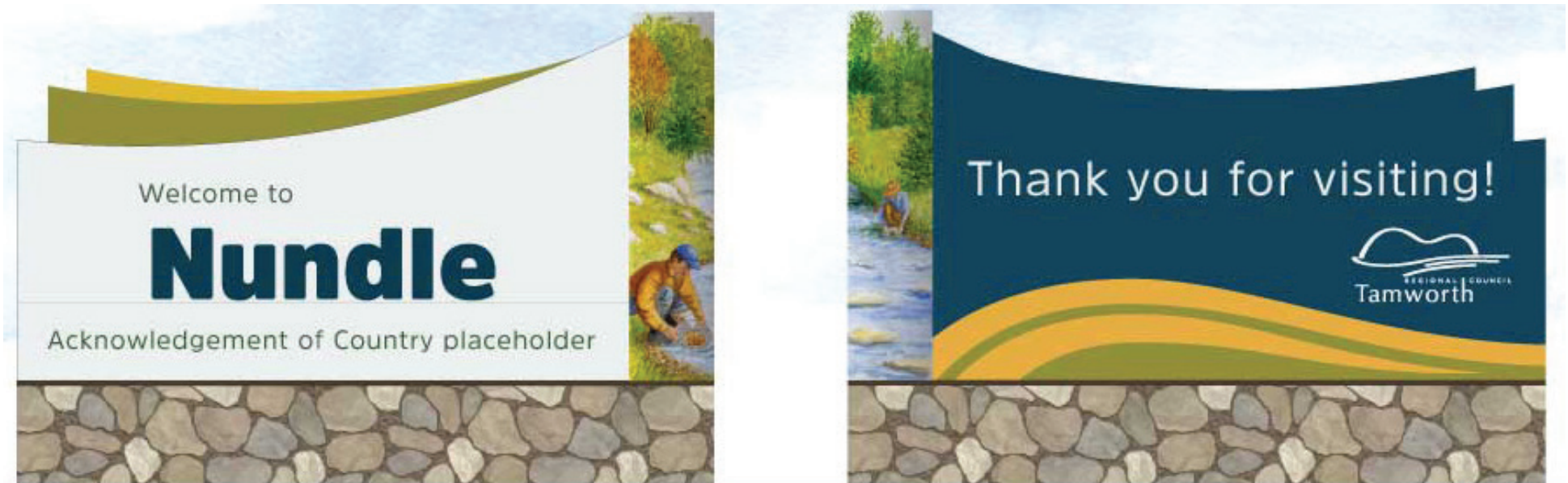

Figure 12 Tier 2 Nundle Signage Design (Source: Danthonia Designs Pty Ltd)

Entrance Strategy Executive Summary



5.2.3 TIER 3 SIGNAGE DESIGN

The Tier 3 sign panel has an overall size of 2.2 metres long by 1.51 metres high, set on 100mm x 2.6m poles to an overall size of 2.42 metres wide by 2.88 metres high. The place lettering is retro reflective vinyl to improve visibility at night. The sign can be read from a distance of 80 metres.



Figure 13 Tier 3 Signage Design (Source: Danthonia Designs Pty Ltd)

Entrance Strategy Executive Summary

5.2.4 TIER 4 SIGNAGE DESIGN

TIER 4 CATEGORY A SIGN

The Tier 4 category A sign has an overall size of 4.87 metres long by 3.34 metres high. The Tamworth Regional Council lettering is 580 millimetres high, retro reflective vinyl to improve visibility at night. The sign can be read from a distance of 200 metres. It is proposed that all Tier 4 category A signs will be uplit with solar lighting.



TIER 4 CATEGORY B SIGN

The Tier 4 sign panel has an overall size of 2.2 metres long by 1.51 metres high, set on 100mm x 2.6m poles to an overall size of 2.42 metres wide by 2.88 metres high. The place lettering is retro reflective vinyl to improve visibility at night. The sign can be read from a distance of 70 metres.

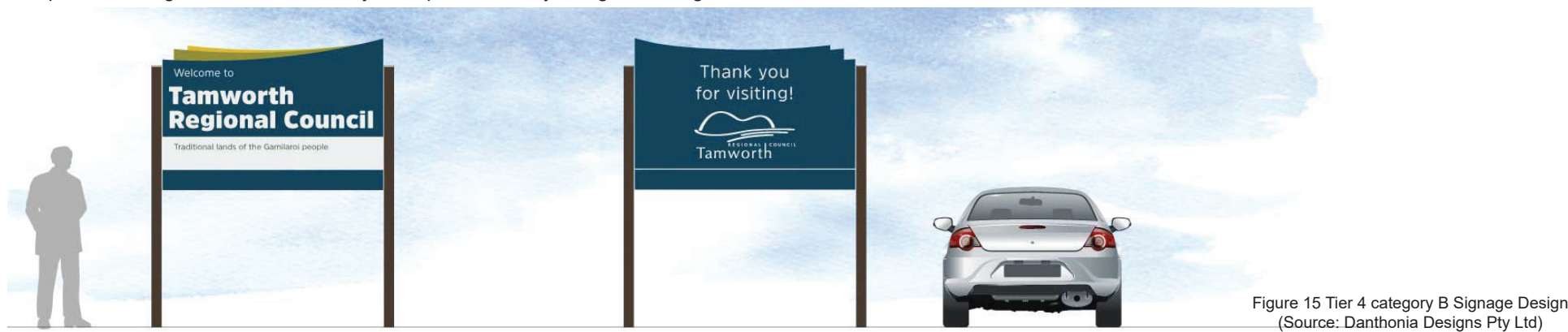



Entrance Strategy Executive Summary

6 PRIORITISATION OF WORKS AND FUNDING

The following section of this report outlines the recommended actions, prioritisation of works and budget estimates for each component.

The Prioritisation of works and Funding Table highlights the priority of works and associated budget estimates as of time of publication of this strategy, which will aid in the future budget allocations and grant opportunities.

Refer to the full Entrance Strategy for the full rationale for recommendations in each location.

Priority of works has been set to high, medium or low. Generally the roll out of signage will be prioritised by Tier 1, 4, 2 and 3 signage.

Location	Action/Recommendation	Priority	Indicative Budget Estimate
TIER 1 LOCALITIES			
Oxley Highway / Gunnedah Road	Tier 1 sign installation	High	\$53,540.00
	Flora Corridor (approximately 1.9 kilometres)	Medium	\$14,400.00
	Roundabout beautification	Medium	\$21,100.00
	Public Art installation on Oxley Highway near Country Road Roundabout	Low	\$60,000.00
		SUB TOTAL	\$149,040.00
New Winton Road / Armidale Airport	Tier 1 sign installation	High	\$53,540.00
	Flora Corridor (approximately 1440 metres)	Medium	\$7,875.00
		SUB TOTAL	\$61,415.00
Tamworth New England Highway (Armidale Road)	Tier 1 Entrance Wall to replace existing wall	High	\$53,540.00
	Demolish existing entrance wall	High	\$5,000.00
	Flora Corridor & Infill Street Tree planting (approximately 3.2 kilometres)	Medium	\$9,600.00
		SUB TOTAL	\$68,140.00
Tamworth New England Highway (Goonoo Goonoo Road)	Tier 1 Entrance Signage installation	High	\$53,540.00
	Roundabout beautification	Medium	\$7,000.00
		SUB TOTAL	\$60,540.00
Tamworth Duri Road	Tier 1 Entrance Signage Installation at Burgmanns Lane	High	\$53,540.00
		SUB TOTAL	\$53,540.00



Entrance Strategy Executive Summary

Tamworth Manilla Road	Tier 1 Entrance Signage Installation	High	\$53,540.00
	Public art installation near intersection of Glengarvin Drive	Low	\$60,000.00
	Flora Corridor & Infill Street Tree planting (approximately 1.4 kilometres)	Medium	\$6,300.00
		SUB TOTAL	\$119,840.00
TIER 1 TOTAL			\$512,515.00

TIER 2 LOCALITIES			
Barraba	Tier 2 sign installation Northern side of Barraba on Bingara Road	High	\$40,236.00
	Tier 2 sign installation Southern side of Barraba on Manilla Road	High	\$40,236.00
	Remove two (2) 'Regent Honey Eater' signs	High	\$900.00
	Remove portrait style signage	High	\$1,200.00
	Flora Corridor (approximately 1.6 kilometres)	Medium	\$9,600.00
	Central Median in Alice Street	Low	\$24,500.00
		BARRABA TOTAL	\$116,672.00
Bendemeer	Tier 2 sign installation on Southern side of Bendemeer	High	\$40,236.00
	Tier 2 sign installation on Northern side of Bendemeer	High	\$40,236.00
	Flora Corridor (approximately 500 metres)	Medium	\$1,500.00
	Public Art Installation at the McDonald River	Low	\$60,000.00
	Remove two (2) 'Bendemeer Welcomes You' signs	High	\$900.00
	Remove existing timber sign in new sign location	High	\$450.00
		BENDEMEER TOTAL	\$143,322.00
Kootingal	Tier 2 sign installation on Northern side of Kootingal	High	\$40,236.00
	Tier 2 sign installation on Southern side of Kootingal	High	\$40,236.00
	Flora Corridor (approximately 2.4 kilometres)	Medium	\$7,200.00
	Public Art Installation	Low	\$60,000.00
	Remove two (2) groupings of portrait style signage	High	\$2,400.00
		KOOTINGAL TOTAL	\$150,072.00

Entrance Strategy Executive Summary



TIER 2 LOCALITIES CONTINUED			
Manilla	Tier 2 sign installation on Northern side of Manilla	High	\$40,236.00
	Tier 2 sign installation on Southern side of Manilla	High	\$40,236.00
	Design and Installation of Public Art	Low	\$60,000.00
	Flora corridor along Arthur Street (approximately 1.5 kilometres)	Medium	\$5,625.00
	Flora corridor along Court Street (approximately 370 metres)	Medium	\$2,100.00
	Remove two (2) 'Welcome to Manilla' sign	High	\$900.00
	Remove two (2) timber 'Welcome to Manilla' sign	High	\$900.00
	Remove 'Welcome to Manilla' sign on Rushes Creek Road	High	\$450.00
MANILLA TOTAL			\$150,447.00
Moonbi	Installation of Tier 2 sign on New England Highway northern side of Moonbi	High	\$40,236.00
	Installation of Tier 2 sign on New England Highway southern side of Moonbi	High	\$40,236.00
	Flora Corridor (approximately 1.5 kilometres)	Medium	\$5,625.00
	Public Art installation in Moonbi Park	Low	\$60,000.00
	Removal of two (2) existing welcome signs	High	\$900.00
MOONBI TOTAL			\$146,997.00
Nundle	Tier 2 sign installation on Eastern side on Nundle	High	\$40,236.00
	Tier 2 sign installation on western side of Nundle	High	\$40,236.00
	Avenue of 10 trees in accordance with USTMP	Medium	\$750.00
	Remove single post brown 'Nundle' sign	High	\$450.00
	Remove two (2) 'Welcome to Nundle' sign	High	\$900.00
	Remove portrait style signage	High	\$1200.00
	Public Art Installation	Low	\$60,000.00
	Install small sign commemorating the Tidy Town accolades in the Nundle Park	High	\$500.00
NUNDLE TOTAL			\$144,272.00
TIER 2 TOTAL			\$851,782.00



Entrance Strategy Executive Summary

TIER 3 LOCALITIES			
Attunga	Two (2) Tier 3 sign installation	High	\$22,444.00
	Flora corridor	Medium	\$1,500.00
	Remove two (2) existing style B signs	High	\$900.00
	Remove two (2) existing style A signs	High	\$900.00
ATTUNGA TOTAL			\$25,744.00
Duruka	Two (2) Tier 3 sign installation	High	\$22,444.00
	Flora Corridor in Duruka	Medium	\$1,500.00
DURUKA TOTAL			\$23,944.00
Dungowan	Remove existing signage and install Tier 3 sign on Nundle Road	High	\$11,672.00
	Remove existing signage and install Tier 3 sign on Nundle Road	High	\$11,672.00
	Remove existing signage and install Tier 3 sign on Ogunbil Road	High	\$11,672.00
	Flora Corridor in Dungowan	Medium	\$1,500.00
	Remove existing signage (E 322255, N 6544362)	High	\$450.00
DUNGOWAN TOTAL			\$36,966.00
Duri	Remove existing signage and install Tier 3 sign (E 292171, N 6543983)	High	\$11,672.00
	Remove existing signage and install Tier 3 sign (E 292724, N 6544872)	High	\$11,672.00
	Flora Corridor in Duri	Medium	\$1,500.00
DURI TOTAL			\$24,844.00
Hanging Rock	Remove existing signage and install Tier 3 sign (E 327941, N 6515779)	High	\$11,672.00
	Tier 3 sign installation (E 328736, N 6513593)	High	\$11,222.00
	Flora Corridor in Hanging Rock	Medium	\$1,500.00
	Remove other existing signage	High	\$750.00
HANGING ROCK TOTAL			\$25,144.00



Entrance Strategy Executive Summary

Limbri	Tier 3 sign installation (E 324301, N 6564643)	High	\$11,222.00
	Tier 3 sign installation (E 324101, N 6564591)	High	\$11,222.00
	Remove existing two (2) Limbri signs	High	\$900.00
	Flora Corridor in Limbri	Medium	\$1,500.00
		LIMBRI TOTAL	\$24,844.00
Nemingha	Remove existing signage and install Tier 3 sign (E 307324, N 6554875)	High	\$11,672.00
	Remove existing signage and install Tier 3 sign (E 308576, N 6555069)	High	\$11,672.00
	Flora corridor in Nemingha	Medium	\$1,500.00
		NEMINGHA TOTAL	\$24,844.00
Niangala	Flora Corridor in Niangala	Medium	\$1,500.00
	Remove two (2) existing RMS style signage	High	\$1,350.00
	Install two (2) Tier 3 sign	High	\$22,444.00
		NIANGALA TOTAL	\$25,294.00
Piallamore	Install Tier 3 sign and remove existing signage (E 315504, N 6550210)	High	\$11,672.00
	Install Tier 3 sign and remove existing signage (E 314742, N 6550803)	High	\$11,672.00
	Remove three (3) existing signs (E 314822, N 6550791, E 315504, N 6550210 and E 315504, N 6550210)	High	\$1,350.00
	Flora Corridor in Piallamore	Medium	\$1,500.00
		PIALLAMORE TOTAL	\$26,194.00
Somerton	Install two (2) Tier 3 sign	High	\$22,444.00
	Remove two (2) existing signs	High	\$900.00
	Flora Corridor	Medium	\$1,500.00
		SOMERTON TOTAL	\$24,844.00
Woolbrook	Replace existing signage near Oxley Highway with Tier 3 sign	High	\$11,672.00
	Replace existing signage on Danglemah Road with Tier 3 sign	High	\$11,672.00
	Flora Corridor in Woolbrook	Medium	\$1,500.00
		WOOLBROOK TOTAL	\$24,844.00



Entrance Strategy Executive Summary

Woolomin	Replace two (2) existing signs with new Tier 3 signs	High	\$22,444.00
	Flora Corridor in Woolomin	Medium	\$1,500.00
	Remove two (2) existing signs	High	\$900.00
		WOOLOMIN TOTAL	\$24,844.00
		TIER 3 TOTAL	\$312,350.00
TIER 4 LOCALITIES			
Tier 4 Category A - Installation of seven (7) tier 4 signs in locations noted in section 5.3.4 of this report.		High	\$374,780.00
		TIER 4 CAT. A TOTAL	\$374,780.00
Tier 4 Category B- Installation of eight (8) tier 4 signs in locations noted in section 5.3.4 of this report.		High	\$428,320.00
		TIER 4 CAT. B TOTAL	\$428,320.00
TIER 4 TOTAL			\$803,100.00

FUNDING SUMMARY

PRIORITY WORKS	TOTAL
HIGH PRIORITY	\$1,918,572.00
MEDIUM PRIORITY	\$116,675.00
LOW PRIORITY	\$444,500.00
	\$2,479,747.00

TIER	TOTAL
TIER 1	\$512,515.00
TIER 2	\$851,782.00
TIER 3	\$312,350.00
TIER 4	\$803,100.00
	\$2,479,747.00